

BRC Fire and Acoustic System for Upgrading Timber Floors.

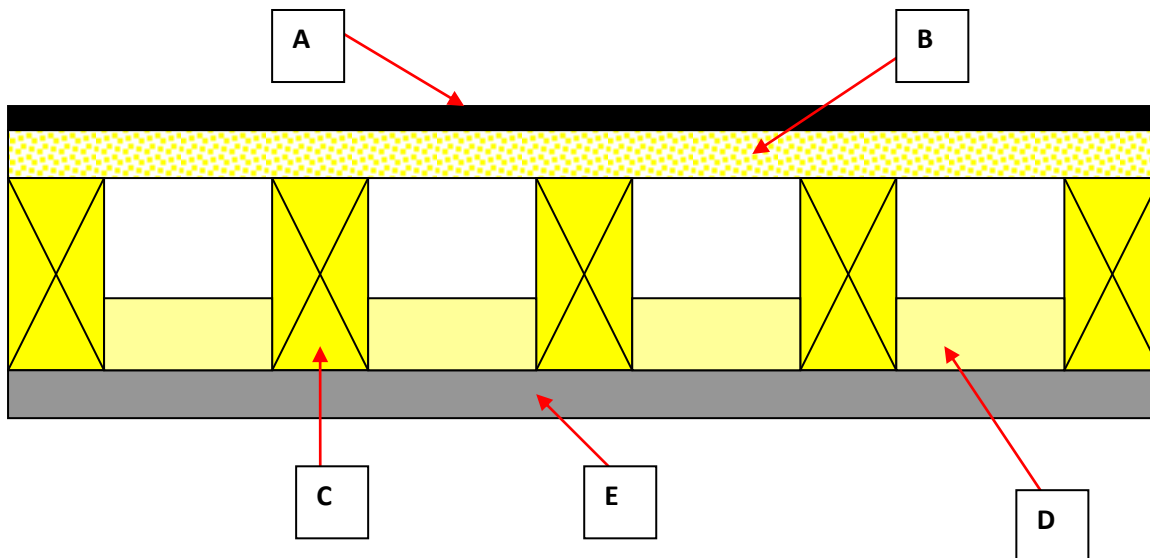

- A = ACOUSTIC LAYER DEPENDENT UPON FINAL FLOOR FINISH**
B = TYPICAL T&G CHIPBOARD OR PLYWOOD DECK OR T&G FLOORBOARDS
C = 150mm x 50mm TIMBER JOISTS @ 400mm CENTRES
D = 70mm THICKNESS BRC FIRE COATED SLAB FRICTION FITTED BETWEEN JOISTS AND SEALED WITH FIRE & ACOUSTIC SEALANT
E = TYPICAL 20mm LATH AND PLASTER CEILING OR PLASTERBOARD

Typical installation between Joists



These slabs are relatively simple to install but must be cut oversize by 5mm between the joists to allow for a good friction fit. All joins and abutments must be sealed with a compatible fire and acoustic acrylic sealant.

Services may run over the top of the slab system but where the service penetrates the slab gaps must be sealed with a compatible fire and acoustic acrylic sealant.